



# MAVERICK MANAGEMENT CORP

1000 Pennsylvania Avenue  
Brooklyn, NY 11207

## STORE FOR RENT

### 2330 N Front Street Philadelphia, PA

Great Retail Space Available



- ± 5,150 Sq. Ft. On The 1st Floor — Basement Available For Storage
- ± 48 Feet of Frontage On N. Front Street
- In The Block of The N. Front Street Shopping District
- Formally Occupied By Valu-Plus

#### DEMOGRAPHICS (\*)

	1 Mile	3 Miles	5 Miles
2007 Population	63,345	370,085	940,247
2007 Median HH Income	\$23,772	\$29,768	\$34,239
2007 Households	19,999	131,255	352,579

#### Join These Retailers



\* Data Source: 2008, Site USA, Chandler, Arizona

**Contact: Martin Wolf | 718-485-3682 x240 | leasewithmarty@aol.com**  
**Abe Chehebar | 718-485-3682 x463 | achehebar@rainbow-mail.com**



# MAVERICK MANAGEMENT CORP

1000 Pennsylvania Avenue  
Brooklyn, NY 11207

**2330 N Front Street  
Philadelphia, PA 19133**

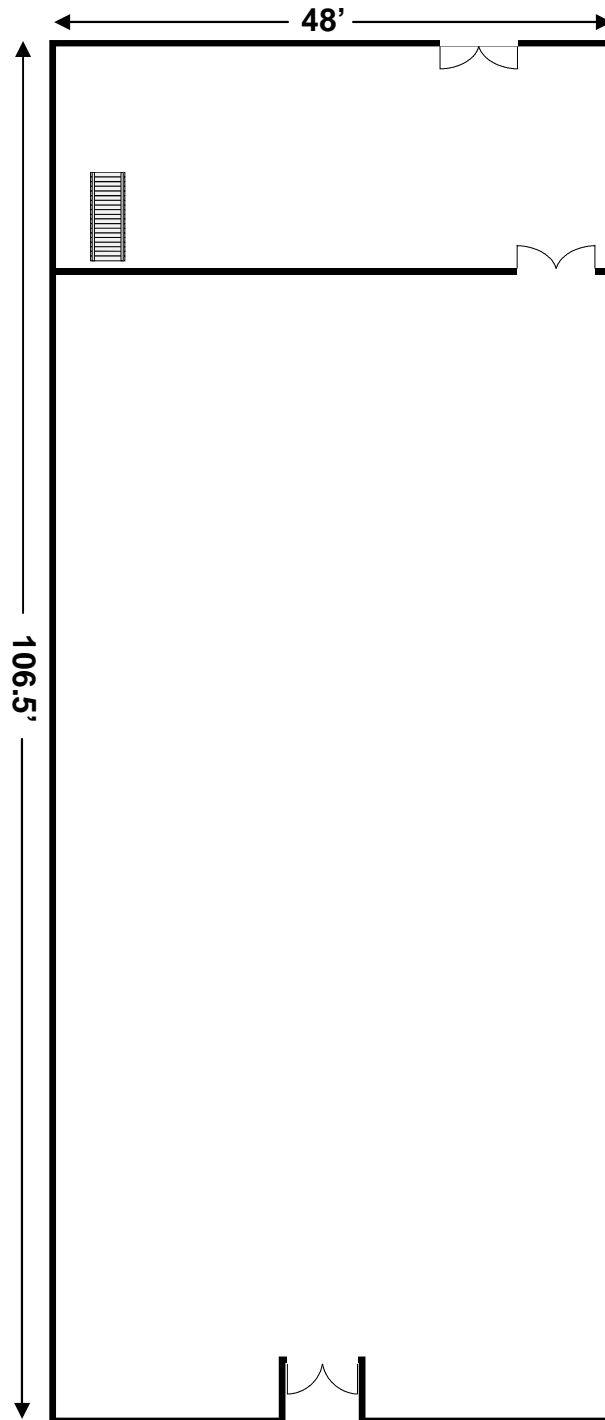

FRONT STREET

**Contact: Martin Wolf | 718-485-3682 x240 | [leasewithmarty@aol.com](mailto:leasewithmarty@aol.com)  
Abe Chehebar | 718-485-3682 x463 | [achehebar@rainbow-mail.com](mailto:achehebar@rainbow-mail.com)**



# MAVERICK MANAGEMENT CORP

1000 Pennsylvania Avenue  
Brooklyn, NY 11207

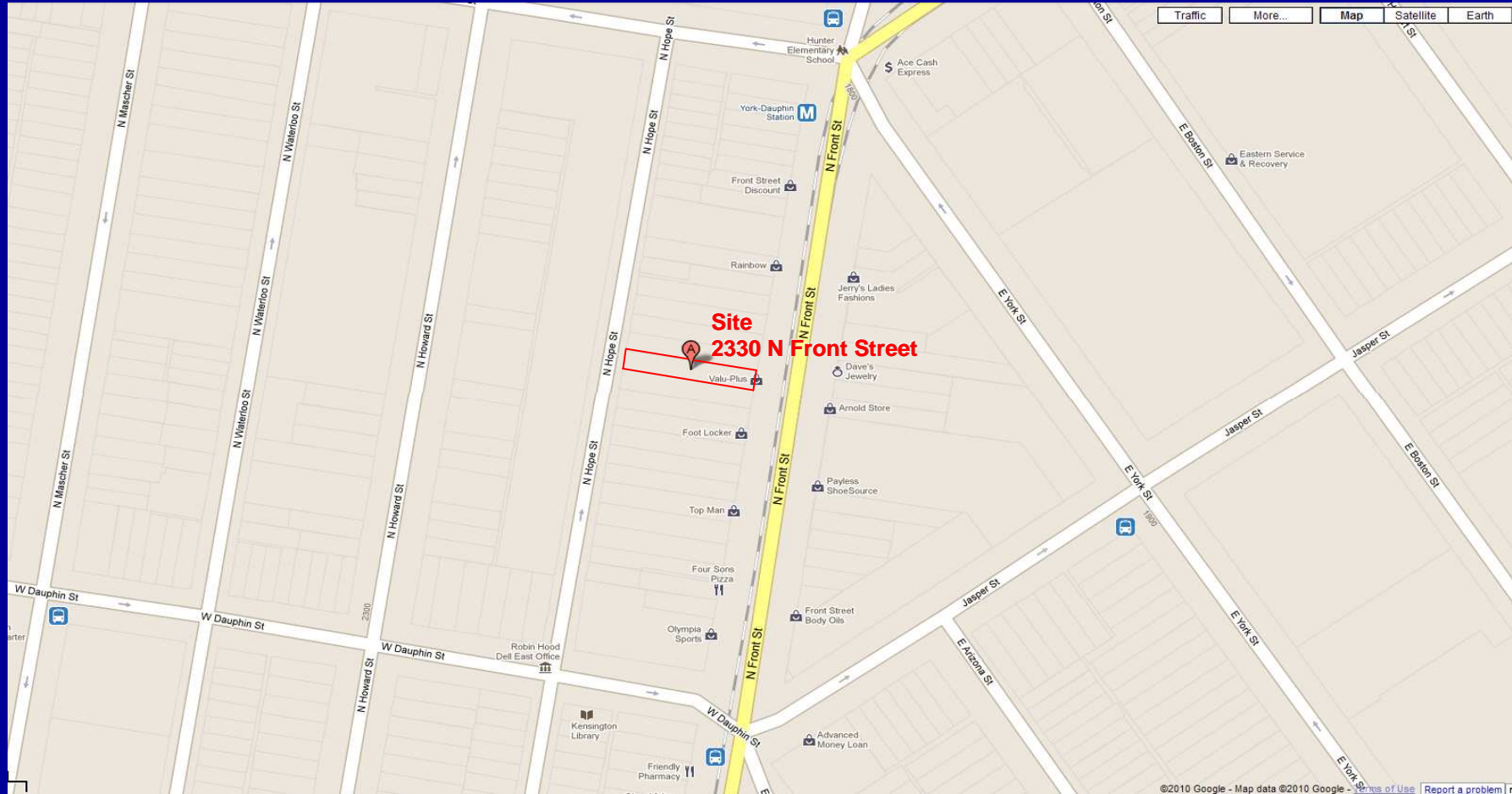

## 2330 N Front Street

Philadelphia, PA 19133

**Contact: Martin Wolf | 718-485-3682 x240 | [leasewithmarty@aol.com](mailto:leasewithmarty@aol.com)  
Abe Chehebar | 718-485-3682 x463 | [achehebar@rainbow-mail.com](mailto:achehebar@rainbow-mail.com)**